

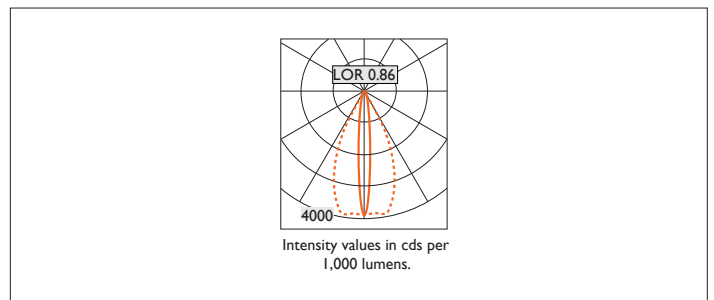

GRAZER LED

GRAZER LED can be surface mounted or suspended from the ceiling. It consists of an aluminium extruded profile in various chassis lengths as individual modules, and comes complete with integral driver. Optical control is provided by precise lenses.

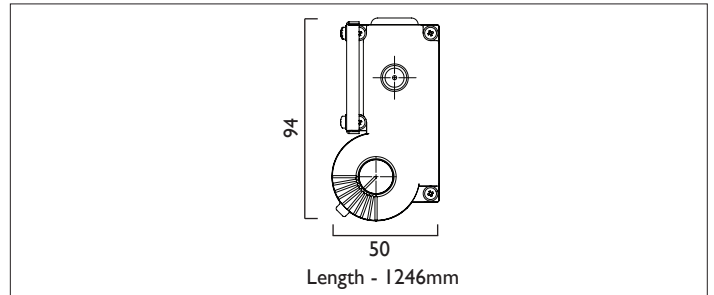

| | |
|----------------|--------------------------------|
| Product Number | L4704 |
| Lamp Type | LED, 3360 lumens, 4000K, Ra>80 |
| Construction | Aluminium / Steel / Plastic |
| Diffuser | Clear / Elliptical |
| Finish | Black |
| IP | IP20 |
| Control | Driver |

